



**CRIO&ENG S.R.L.**

Piazza San Marco, 1  
20121 Milano  
Tel. 02/290.14.281 - Fax 02/65.99.036  
e-mail: crioeng@5pengineering.it

**TECHNICAL SPECIFICATION OF WATER VAPORIZER AT LOW PRESSURE  
WITH PRESSURIZED SHELL SIDE**

CLIENT	JOB N°				SPECIFICATION N° 001-2000AR			
<b>TYPE</b>	<b>1000</b>	<b>1500</b>	<b>2500</b>	<b>3500</b>	<b>5000</b>	<b>7500</b>	<b>10.000</b>	<b>20.000</b>
<b>N2 FLOW RATE Nm3/h</b>	<b>1000</b>	<b>1500</b>	<b>2500</b>	<b>3500</b>	<b>5000</b>	<b>7500</b>	<b>10.000</b>	<b>20.000</b>
<b>SURFACE m2</b>	<b>6</b>	<b>9</b>	<b>16</b>	<b>22</b>	<b>33</b>	<b>44</b>	<b>55</b>	<b>110</b>

Pos.	CONNECTIONS LIST AND OVERALL DIMENSIONS								
A	Liquid Inlet	ND 25	ND 25	ND 25	ND 40	ND 50	ND 50	ND 65	ND 80
B	Gas Outlet	ND 50	ND 65	ND 80	ND 125	ND 150	ND 150	ND 200	ND 250
C	Water Inlet	ND 80	ND 100	ND 100	ND 100	ND 125	ND 125	ND 150	ND 200
D	Water Outlet	ND 80	ND 100	ND 100	ND 100	ND 125	ND 125	ND 150	ND 200
E	Pressure builder inlet	ND 25	ND 25	ND 25	ND 25	ND 25	ND 25	ND 40	ND 40
F	Pressure builder outlet	ND 40	ND 40	ND 40	ND 40	ND 40	ND 40	ND 50	ND 80
G	Vessel Internal dia. mm	900	1100	1300	1500	2100	2100	2100	2500
H	Maximum Height mm	2342	2422	2600	5200	5200	5200	5500	5700
I	Nozzles Projection mm	2412	2422	2600	5100	5100	5100	5400	5600
L	Earth Distance mm	335	285	325	500	500	500	500	500

**DESIGN DATA**

DATA	SHELL SIDE	PROCESS SIDE
DESIGN PRESSURE bar	7	15
DESIGN TEMPERATURE °C	+10/50	-196 /+ 100
WORKING PRESSURE bar	4	15
WORKING TEMPERATURE *C	+ 20/40	-180/+20
FLUID CONTENT	WATER	NITROGEN / OXIGEN
CORROSION mm	0	0

**C&E CAN SUPPLY VAPORIZER HAVING STEAM - WATER FLUID INTO THE SHELL SIDE  
FURTHERMORE THEY CAN BE EQUIPPED WITH THE PRESSURE BUILDER COIL ON REQUEST**

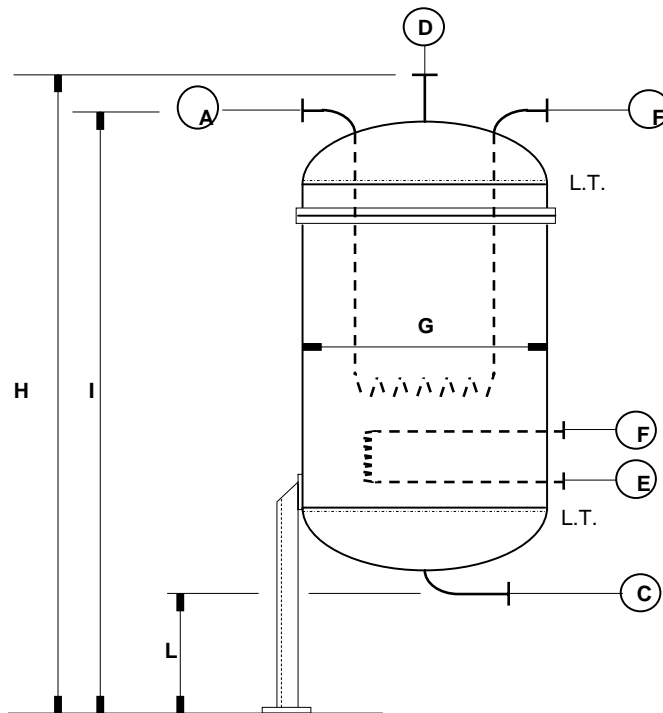

0				
REV.	DESCRIPTIONS	DRAF.	DATE	CHECK DATE